

# Thermopile sensor

## TS-S2NAU-2C

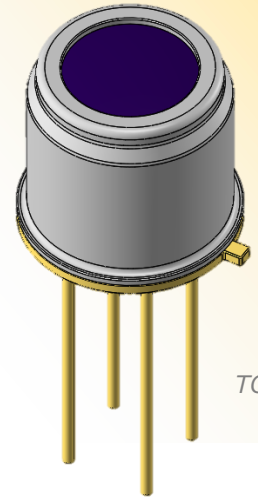

TO-5

■ Applications Non-contact thermometer

■ Feature Object-Sensor temperature detection (2-channel)  
 Focused detection(Single element)

### Dimensions

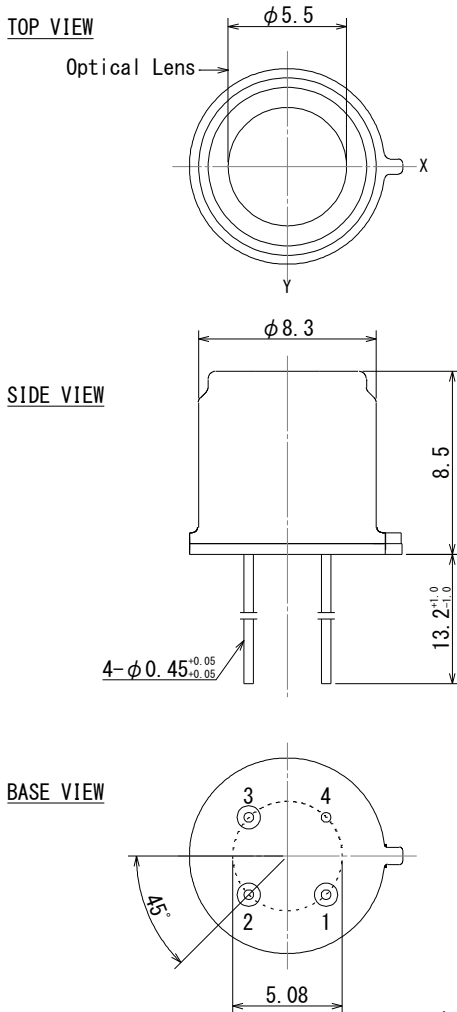

### FOV

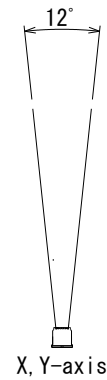

### Circuit diagram

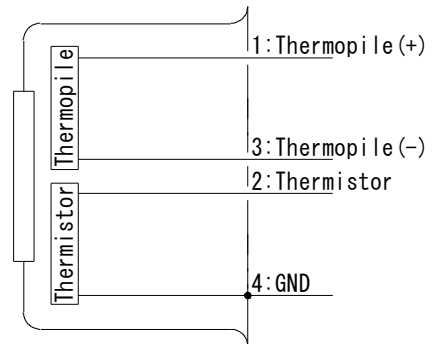

Tolerance without instruction : +/- 0.2

### ■ Main Parameters

| Parameters               | Condition               | Spec. |      |      | Units |
|--------------------------|-------------------------|-------|------|------|-------|
|                          |                         | Min.  | Typ. | Max. |       |
| Sensitivety Output       | 323K at shutter opening | 0.42  | 0.57 | 0.71 | mV    |
| Resistance of thermopile |                         | 145   | 175  | 205  | kΩ    |
| Thermistor resistor      |                         | 95    | 100  | 105  | kΩ    |
| Operating Temperature    |                         | -30   |      | 80   | °C    |
| Time Constant            |                         | 25    | 50   | 80   | msec. |